

Cup Cake Holder.



1. Cut a square piece of backing paper 20cm x 20cm. (Fig 1).
2. Turn your paper over and draw a faint line from corner to corner, (fig 2). Turn the paper round and draw another faint line from corner to corner to create a cross to find the centre of your paper, (fig 3).

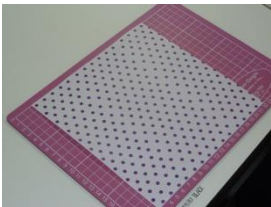

Fig 1



Fig 2



Fig 3

3. Fold each corner into the centre as in fig 4, fig 5 and fig 6.



Fig 4



Fig 5



Fig 6

4. Next fold two sides into the middle as in fig 7 and fig 8. Unfold these folds and turn your paper (fig 9). Do the same fold to the other sides, (fig 10).

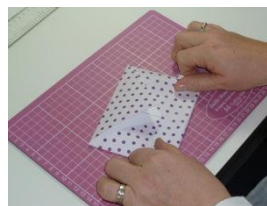

Fig 7



Fig 8



Fig 9

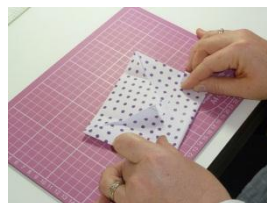

Fig 10

5. Unfold your paper and cut up 2 squares on one side as in fig 11. Do the same on the adjacent side as in fig 12.



Fig 11

Fig 12

6. Turn your paper around and do the same to the opposite side as in fig 13 and fig 14.

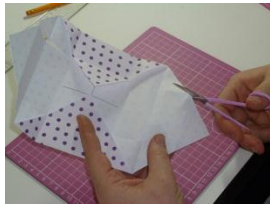

Fig 13



Fig 14

7. Turn your paper and fold up the sides as in fig 15. Tuck the tabs in to meet as in fig 16. Lift up and turn the remaining piece over and tuck down the flap as in fig 17 and fig 18.

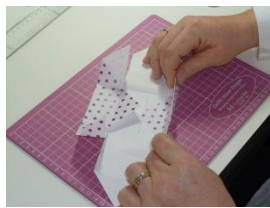

Fig 15



Fig 16

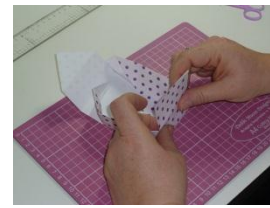

Fig 17



Fig 18

8. Turn your paper and repeat to the other side (fig 19. Fig 20 and fig 21).



Fig 19



Fig 20

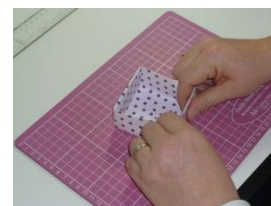
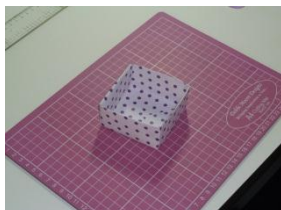

Fig 21

9. Your finished box should look something like this (fig 22).



10. Make 6 boxes in contrasting colours using the above technique. Cut out a rectangular piece of thick card 21cm x 14cm for your base and two 3.5cm x 28cm for your handles. Position

your boxes on the base then attach your handles under where the middle boxes will be. Attach your boxes with double sided tape. Attach your handles together at the top by putting a slot in each side and slotting them together. Decorate your boxes and handles with gems and embellishments.

11. Put 6 cupcakes in the boxes and enjoy.